

Music is borderless and timeless, touching people's hearts across cultures and generations.
Each day the discovery of a truly emotive experience from an unencountered sound awaits.
Let us take you on your journey to rediscover music.

Rediscover Music™ / **Technics**

Delivering the Ultimate Emotive Musical Experience to All

At Technics we understand that the listening experience is not purely about technology but the magical and emotional relationship between people and music.

We want people to experience music as it was originally intended and enable them to feel the emotional impact that enthuses and delights them.

Through delivering this experience we want to support the development and enjoyment of the world's many musical cultures. This is our philosophy.

With a combination of our love of music and the vast high-end audio experience of the Technics team, we stand committed to building a brand that provides the ultimate emotive musical experience by music lovers, for music lovers.

Director
Michiko Ogawa

A handwritten signature in black ink that reads "Michiko Ogawa". The signature is fluid and cursive, with a long horizontal stroke extending from the end of the name.

Thank you for purchasing this product.

Please read these instructions carefully before using this product, and save this manual for future use.

- About descriptions in these operating instructions
 - The illustrations shown may differ from your unit.

For the U.S.A. and Canada

If you have any questions, visit:

U.S.A.:

<http://shop.panasonic.com/support>

Canada:

<http://panasonic.ca/english/support>

Register online at

<https://shop.panasonic.com/RegisterTechnics>

(U.S. customers only)

For the United Kingdom and Ireland customer

Sales and Support Information

Customer Communications Centre

- For customers within the UK: 0333 222 8777
- For customers within Ireland: 01 447 5229
- Monday–Friday 9:00 am – 5:00 pm, (Excluding public holidays).
- For further support on your product, please visit our website:
www.technics.com/uk/

Table of contents

Safety precautions	05	Others	09
Features.....	05	Limited Warranty (ONLY FOR	
About this unit.....	06	U.S.A.)	10
Installation	07	Limited Warranty (ONLY FOR	
Connections	08	CANADA)	11

Disposal of Old Equipment

Only for European Union and countries with recycling systems



This symbol on the products, packaging, and/or accompanying documents means that used electrical and electronic products must not be mixed with general household waste.

For proper treatment, recovery and recycling of old products, please take them to applicable collection points in accordance with your national legislation.

By disposing of them correctly, you will help to save valuable resources and prevent any potential negative effects on human health and the environment.

For more information about collection and recycling, please contact your local municipality.

Penalties may be applicable for incorrect disposal of this waste, in accordance with national legislation.

Safety precautions

Warning

- Put the speakers on a flat safe surface.
- Do not hang the speakers from the ceiling or on the wall. Doing so may cause the speaker to fall off, causing personal injury.
- Do not place any objects in the bass reflex ports on the front of the speakers. Doing so may cause fire or personal injury. Pay close attention to children.
- Do not repair the speakers by yourself. Refer servicing to qualified service personnel.

Caution

- Do not stand on the speakers.
- Do not place heavy items on the speakers.
- Do not hold the speaker in one hand to avoid injury by dropping the speaker when carrying.
- Do not expose the speakers to direct sunlight, high temperatures, high humidity, and excessive vibration.

- Do not expose the speakers to rain, moisture, dripping or splashing.
- The speakers and speaker nets use powerful magnets. Do not put them near TVs, PCs or other equipment easily influenced by magnetism.
- You can damage your speakers and shorten their useful life if you play sound at high levels over extended periods.
- Do not touch the diaphragms. Doing so may deform the diaphragms, and as a result, sound may not be output correctly.
- Be cautious when children are near.
- Do not insert a finger into the bass reflex ports on the front of the speakers. Pay close attention to children as doing so may cause personal injury.
- Keep your speakers at least 10 mm ($13/32$ ") away from the system for proper ventilation.

English

Features

Coaxial Two-Way Unit achieves clearer sound image localisation, and smooth and pleasant sound

A uniquely shaped phase plug, shallow type of woofer diaphragm and the edge smoothly lined up from diaphragm to baffle are introduced on the newly developed coaxial unit that inherits the design concepts of point sound source and linear phase reproduction. The coaxial unit Technics has pursued generates spherical waveforms to achieve clearer sound image localisation, and smooth and pleasant sound.

Balanced mounting architecture delivers crisp sound and recreates a three-dimensional soundstage

The speaker unit is mounted at the gravity centre position on the mounting-baffle provided inside the cabinet to minimise the vibrations of the speaker unit and unnecessary vibrations generated from the baffle. This mechanism delivers crisp sound and recreates a three-dimensional

Bass reflex port offers excellent low range reproduction with superb response

By reference to the airstream controlling method in aeronautical engineering, the bass reflex port designed with the fluid analysis is mounted on the front of this unit to reduce the airflow turbulence occurring around the open area of the bass reflex port and offer low range reproduction with superb response and low noise.

About this unit

Accessories

Speaker cables (Approx. 1.5 m) (2)
TQBGA022

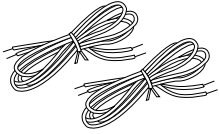

Speaker nets (2)
TTJ0062

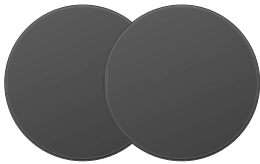

- Product numbers provided in these operating instructions are correct as of August 2021.
- These may be subject to change.

Names of parts

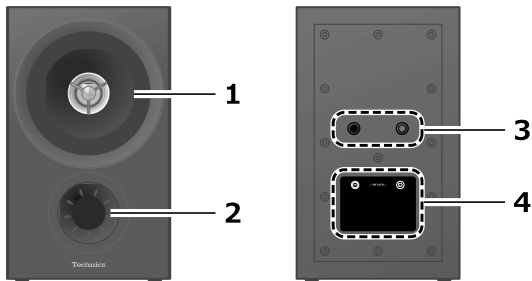

01 Speaker unit (Coaxial 2-way unit)

02 Bass reflex port

03 Speaker input terminals

04 Product identification marking

- The model number is located on the Product Identification Marking on the rear of this unit.

Attaching and removing the speaker nets

The speaker nets protect the speaker units from dust. Use the magnets to fix the speaker nets to the speakers.

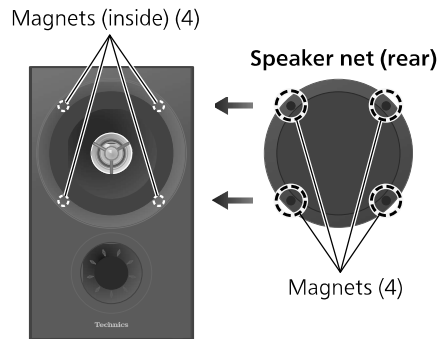

- Attach the speaker nets so that they fully cover the speaker units.
- Attach the speaker nets at the positions to meet the magnets and there is no specific direction of up and down, left and right.
- The superior sound quality can be delivered when playing back without the speaker nets.

For optimum position

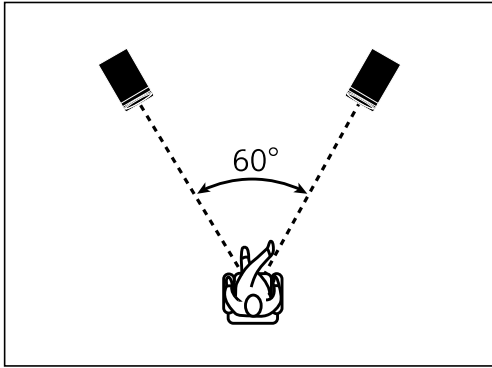

(The angle is approximate.)

- Do not touch the speaker units. Doing so may result in incorrect audio quality.
- Place the speakers at approximately the same distance from the listening position.
- Keep the amplifier or any other device and the speakers at least 1 cm ($13/32$ ") away from each other.

■ For optimum position

The quality and volume of the bass sound, sound localisation performance, sound ambience, and other factors that determine the audio quality vary depending on the installation location of this unit, listening position, room conditions, and other factors. Refer to the information below when installing the speakers.

Determining an installation location.

- Put the speakers on a flat safe surface.
- To minimise the gap in audio quality between the left and right speakers, install them so that acoustic conditions (reflection and absorption of sound) around them are the same.

Adjusting the distances between the rear of the speakers and the walls

- If you install the speakers close to a wall or in a corner, the bass sound will be more powerful; however, when the speakers are too close to it, sound localisation performance and sound ambience may deteriorate. If this occurs, adjust the distance between the speakers and the front wall, which should be between 30 cm (12") to 60 cm (24"). (Please note that the distance between the speakers and the side walls should be greater than 60 cm (24").)

Adjusting the angle of the speakers

- Angle the front side of the speakers toward the listener. Following these steps will help the speakers deliver more precise sound localisation.

Adjusting the acoustics of the room and speaker layout

- Depending on the room environment (including the size and shape of the room, distance to the walls and reverberation level), certain sounds may be exaggerated or suppressed, making them difficult to hear. In such cases, adjusting the reverberation level by moving the speakers, changing your listening position or covering the walls and windows with thick curtains may help resolve the problem.

Connecting the speaker cables

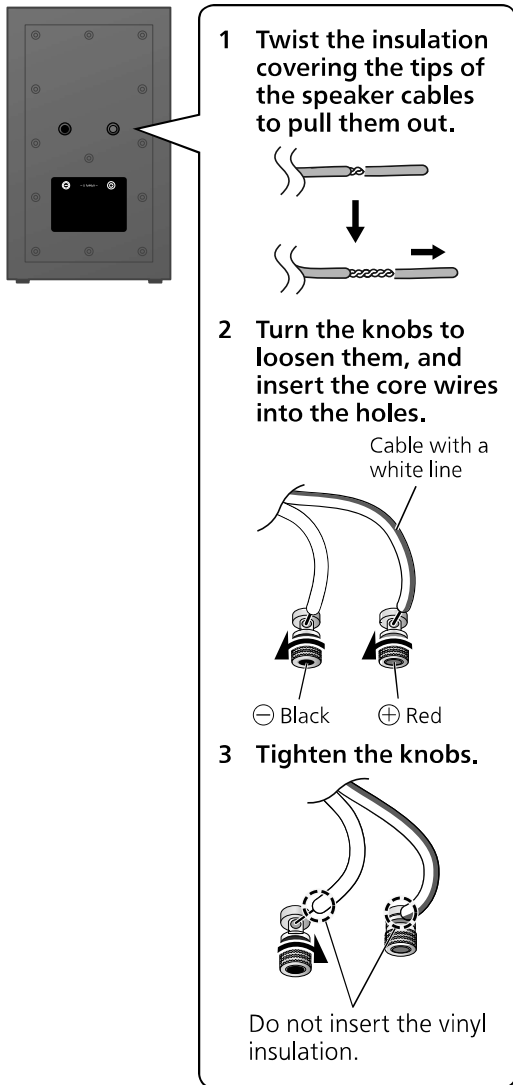

Note

- Be careful not to cross (short-circuit) or reverse the polarity of the speaker wires as doing so may damage the amplifier.

DO NOT

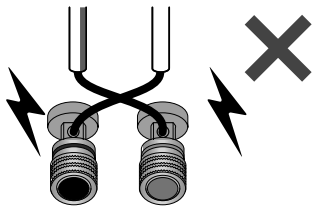

- Check the colors of the speaker cables (supplied) to connect the left and right speakers correctly. Incorrect connection can damage the speakers.

Connecting with an amplifier

- Before connection, turn off the amplifier and disconnect its power cord.
- For details, refer to the operating instructions of the amplifier.

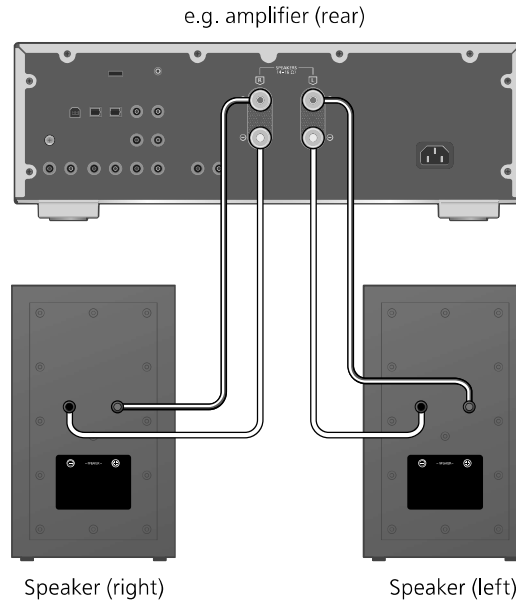

Note

- Do not move the speaker while the speaker cables are connected. This may cause a short circuit.
- When the connections are completed, pull the speaker cables lightly to check that they are connected firmly.
- Wire the polarity (+/-) of the terminals correctly. Not doing so may adversely affect stereo effects or cause malfunction.

Notes on use/Unit Care

To protect the speakers from damage caused by excessive input, observe the following precautions:

- Reduce the volume in the following cases to avoid damage:
 - When playing distorted sound.
 - When the speakers are receiving howling from a microphone or record player, noise from FM broadcasts, or continuous signals from an oscillator, test disc, or electronic instrument.
 - When adjusting the sound quality.
 - When turning the amplifier on or off.
- Avoid raising the volume level too much when enhancing the treble sound with a graphic equalizer or any other controls.
- Avoid outputting excessively loud sound with a small power amplifier. Doing so will increase

the amplifier's harmonic distortion and may damage the speakers.

- You can damage your speakers and shorten their useful life if you play sound at high levels over extended periods.
- Do not touch the speaker terminals with your hands or other objects while the speakers are in use. Depending on the conditions of use, doing so may expose you to high voltage.

Wipe the speakers with the supplied cleaning cloth.

- When dirt is heavy, wring a wet cloth tightly to wipe the dirt, and then wipe it with a dry cloth.
- Do not use solvents including benzine, thinner, alcohol, kitchen detergent, a chemical wiper, etc. This might cause the exterior case to be deformed or the coating to come off.

Specifications

Type	2 WAY 2 SPEAKER Bass-ref (Coaxial 2-way for Woofer and Tweeter Included)
Speaker unit	
Woofer	15 cm (6") Cone Type × 1
Tweeter	2.5 cm (1") Dome Type × 1
Impedance	4 Ω
Input power (IEC)	120 W (MAX), 60 W (RATED)
Sound pressure level	83 dB/2.83 V(m), 80 dB/W(m)
Frequency range	40 Hz to 100 kHz (-10 dB)
Crossover frequency	2 kHz

Dimensions (W × H × D)	173 mm × 293 mm × 283 mm (7" × 11 1/2" × 11 5/32") (include net 8 mm (5/16") and back terminal knob 15 mm (19/32"))
Mass (Weight)	Approx. 6.3 kg (1pc) (14 lbs)
Operating temperature range	0 °C to +40 °C (+32 °F to +104 °F)
Operating humidity range	20 % to 80 % RH (no condensation)

Note

- Specifications are subject to change without notice.
- Mass and dimensions are approximate.

Technics Products – Limited Warranty

Limited Warranty Coverage

If your product does not work properly because of a defect in materials or workmanship, Panasonic Corporation of North America (referred to as "the warrantor") will, for the length of the period indicated on the chart below, which starts with the date of original purchase ("warranty period"), at its option either (a) repair your product with new or refurbished parts, (b) replace it with a new or a refurbished equivalent value product, or (c) refund your purchase price. The decision to repair, replace or refund will be made by the warrantor.

Product or Part Name	Parts	Labor
Technics Speaker System	3 (three) years	3 (three) years
Technics Network CD Receiver		
Technics Stereo Integrated Amplifier		
Technics Turntable System		

During the "Labor" warranty period there will be no charge for labor. During the "Parts" warranty period, there will be no charge for parts. This Limited Warranty excludes both parts and labor for non-rechargeable batteries, antennas, and cosmetic parts (cabinet). This warranty only applies to products purchased and serviced in the United States. This warranty is extended only to the original purchaser of a new product which was not sold "as is".

Mail-In Service--Online Repair Request

Online Repair Request

To submit a new repair request and for quick repair status visit our Web Site at

<http://shop.panasonic.com/support>

When shipping the unit, carefully pack, include all supplied accessories listed in the Owner's Manual, and send it prepaid, adequately insured and packed well in a carton box. When shipping Lithium Ion batteries please visit our Web Site at <http://shop.panasonic.com/support> as Panasonic is committed to providing the most up to date information. Include a letter detailing the complaint, a return address and provide a daytime phone number where you can be reached. A valid registered receipt is required under the Limited Warranty.

IF REPAIR IS NEEDED DURING THE WARRANTY PERIOD, THE PURCHASER WILL BE REQUIRED TO FURNISH A SALES RECEIPT/PROOF OF PURCHASE INDICATING DATE OF PURCHASE, AMOUNT PAID AND PLACE OF PURCHASE. CUSTOMER WILL BE CHARGED FOR THE REPAIR OF ANY UNIT RECEIVED WITHOUT SUCH PROOF OF PURCHASE.

Limited Warranty Limits and Exclusions

This warranty ONLY COVERS failures due to defects in materials or workmanship, and DOES NOT COVER normal wear and tear or cosmetic damage. The warranty ALSO DOES NOT COVER damages which occurred in shipment, or failures which are caused by products not supplied by the warrantor, or failures which result from accidents, misuse, abuse, neglect, mishandling, misapplication, alteration, faulty installation, set-up adjustments, misadjustment of consumer controls, improper maintenance, power line surge, lightning damage, modification, introduction of sand, humidity or liquids, commercial use such as hotel, office, restaurant, or other business or rental use of the product, or service by anyone other than a Factory Service Center or other Authorized Servicer, or damage that is attributable to acts of God.

THERE ARE NO EXPRESS WARRANTIES EXCEPT AS LISTED UNDER "LIMITED WARRANTY COVERAGE".

THE WARRANTOR IS NOT LIABLE FOR INCIDENTAL OR CONSEQUENTIAL DAMAGES RESULTING FROM THE USE OF THIS PRODUCT, OR ARISING OUT OF ANY BREACH OF THIS WARRANTY.

(As examples, this excludes damages for lost time, travel to and from the servicer, loss of or damage to media or images, data or other memory or recorded content. The items listed are not exclusive, but for illustration only.)

ALL EXPRESS AND IMPLIED WARRANTIES, INCLUDING THE WARRANTY OF MERCHANTABILITY, ARE LIMITED TO THE PERIOD OF THE LIMITED WARRANTY.

Some states do not allow the exclusion or limitation of incidental or consequential damages, or limitations on how long an implied warranty lasts, so the exclusions may not apply to you.

This warranty gives you specific legal rights and you may also have other rights which vary from state to state. If a problem with this product develops during or after the warranty period, you may contact your dealer or Service Center. If the problem is not handled to your satisfaction, then write to:

Panasonic Corporation of North America
Consumer Affairs Department 8th Fl.
Two Riverfront Plaza
Newark NJ 07102-5490

PARTS AND SERVICE, WHICH ARE NOT COVERED BY THIS LIMITED WARRANTY, ARE YOUR RESPONSIBILITY.

Shop Accessories!

for all your Technics gear

Go to

<http://shop.panasonic.com/support>

Get everything you need to get the most out of your Technics products
Accessories & Parts for your Camera, Phone, A/V products, TV, Computers & Networking, Personal Care, Home Appliances, Headphones, Batteries, Backup Chargers & more...

Customer Services Directory

For Product Information, Operating Assistance, Parts, Owner's Manuals, Dealer and Service info go to <http://shop.panasonic.com/support>

For the hearing or speech impaired TTY: 1-877-833-8855

As of December 2019

The model number and serial number of this product can be found on either the back or the bottom of the unit.

Please note them in the space provided below and keep for future reference.

MODEL NUMBER SB-C600
SERIAL NUMBER _____

User memo:

DATE OF PURCHASE _____
DEALER NAME _____
DEALER ADDRESS _____
TELEPHONE NUMBER _____

Panasonic Canada Inc.

5770 Ambler Drive, Mississauga, Ontario L4W 2T3

TECHNICS PRODUCT – LIMITED WARRANTY

English

Panasonic Canada Inc. warrants this product to be free from defects in material and workmanship under normal use and for a period as stated below from the date of original purchase agrees to, at its option either (a) repair your product with new or refurbished parts, (b) replace it with a new or a refurbished equivalent value product, or (c) refund your purchase price. The decision to repair, replace or refund will be made by Panasonic Canada Inc.

Technics Speaker System	3 (three) years parts and labour
Technics Network CD Receiver	3 (three) years parts and labour
Technics Stereo Integrated Amplifier	3 (three) years parts and labour
Technics Turntable System	3 (three) years parts and labour

This warranty is given only to the original purchaser, or the person for whom it was purchased as a gift, of a Technics brand product mentioned above sold by an authorized Panasonic dealer in Canada and purchased and used in Canada, which product was not sold "as is", and which product was delivered to you in new condition in the original packaging.

IN ORDER TO BE ELIGIBLE TO RECEIVE WARRANTY SERVICE HEREUNDER, A PURCHASE RECEIPT OR OTHER PROOF OF DATE OF ORIGINAL PURCHASE, SHOWING AMOUNT PAID AND PLACE OF PURCHASE IS REQUIRED

LIMITATIONS AND EXCLUSIONS

This warranty ONLY COVERS failures due to defects in materials or workmanship, and DOES NOT COVER normal wear and tear or cosmetic damage. The warranty ALSO DOES NOT COVER damages which occurred in shipment, or failures which are caused by products not supplied by Panasonic Canada Inc., or failures which result from accidents, misuse, abuse, neglect, mishandling, misapplication, alteration, faulty installation, set-up adjustments, misadjustment of consumer controls, improper maintenance, power line surge, lightning damage, modification, introduction of sand, humidity or liquids, commercial use such as hotel, office, restaurant, or other business or rental use of the product, or service by anyone other than an Authorized Servicer, or damage that is attributable to acts of God.

Dry cell batteries are also excluded from coverage under this warranty.

THIS EXPRESS, LIMITED WARRANTY IS IN LIEU OF ALL OTHER WARRANTIES, EXPRESS OR IMPLIED, INCLUDING ANY IMPLIED WARRANTIES OF MERCHANTABILITY AND FITNESS FOR A PARTICULAR PURPOSE. IN NO EVENT WILL PANASONIC CANADA INC. BE LIABLE FOR ANY SPECIAL, INDIRECT OR CONSEQUENTIAL DAMAGES RESULTING FROM THE USE OF THIS PRODUCT OR ARISING OUT OF ANY BREACH OF ANY EXPRESS OR IMPLIED WARRANTY. (As examples, this warranty excludes damages for lost time, travel to and from the Authorized Servicer, loss of or damage to media or images, data or other memory or recorded content. This list of items is not exhaustive, but for illustration only.)

In certain instances, some jurisdictions do not allow the exclusion or limitation of incidental or consequential damages, or the exclusion of implied warranties, so the above limitations and exclusions may not be applicable. This warranty gives you specific legal rights and you may have other rights which vary depending on your province or territory.

WARRANTY SERVICE

For product operation, repairs and information assistance, please visit our Support page on:

<http://panasonic.ca/english/support>

IF YOU SHIP THE PRODUCT TO A SERVICENTRE

Carefully pack and send prepaid, adequately insured and preferably in the original carton.

Include details of the defect claimed, and proof of date of original purchase.